

RAISED KERBS AND SHELTER TO BE PROVIDED AT EXISTING BUS STOP. LOCAL AUTHORITY TO CONFIRM SHELTER REQUIREMENTS

TACTILE PAVING TO BE PROVIDED AT EXISTING CROSSING POINT

BRASS CASTLE LANE

FULFORD WAY

BUS STOP

BUS STOP

EXISTING SHORT SECTION OF FOOTWAY TO BE WIDENED TO 2.5m

2.5m WIDE FOOTWAY TO BE PROVIDED ALONGSIDE EXISTING ROAD

RAISED KERBS AND SHELTER TO BE PROVIDED AT EXISTING BUS STOP. LOCAL AUTHORITY TO CONFIRM SHELTER REQUIREMENTS

2.5m WIDE FOOTWAY TO BE PROVIDED ALONGSIDE EXISTING ROAD

2.5m WIDE FOOTWAY LINK INTO SITE TO BE PROVIDED

EXISTING SPEED LIMIT SIGNAGE TO BE REMOVED TO SUIT EXTENDED 30mph ZONE (SUBJECT TO TRO)

NEW 5.5m WIDE JUNCTION WITH 6m RADII TO BE PROVIDED

40

NEW 40mph SPEED LIMIT SIGNAGE TO BE PROVIDED (SUBJECT TO TRO)

30

NEW 30mph SPEED LIMIT SIGNAGE TO BE PROVIDED (SUBJECT TO TRO). ACCOMPANYING ROAD MARKINGS TO BE PROVIDED

NOTES

- 1) ALL DIMENSIONS ARE IN METRES UNLESS STATED OTHERWISE
- 2) ALL WORK IS TO BE CARRIED OUT IN ACCORDANCE WITH THE SPECIFICATION FOR HIGHWAYS WORKS AND LOCAL AUTHORITY GUIDANCE
- 3) UNDERGROUND SERVICES ARE PRESENT IN THE AREA. CONTRACTOR IS TO CONFIRM THE PRECISE LINE AND DEPTH OF ANY SERVICES PRIOR TO THE COMMENCEMENT OF ANY EXCAVATION WORKS

KEY

- NEW CARRIAGEWAY CONSTRUCTION
- NEW FOOTWAY CONSTRUCTION

REVISIONS

REV	DESCRIPTION	DATE	BY
A	FIRST ISSUE SPEED LIMIT UPDATED TO 40mph	02/09/21	TS
		13/12/22	AM



BRASS CASTLE LANE
MARTON

STONEBRIDGE HOMES

SECTION 278 WORKS
GENERAL ARRANGEMENT

Drawn By:	TS	DATE:	01/09/2021
Checked:	RC	Scale:	1:250 @ A1
Drawing No:	AMA/20617/D/001	Rev:	A



KEY:
 20 mph speed limit area

**ROMAN ROAD, LINTHORPE:
20MPH SPEED LIMIT**
Drawn: SR Date: Jan 2024 Scale: NTS

Linthorpe
Community
Primary
School

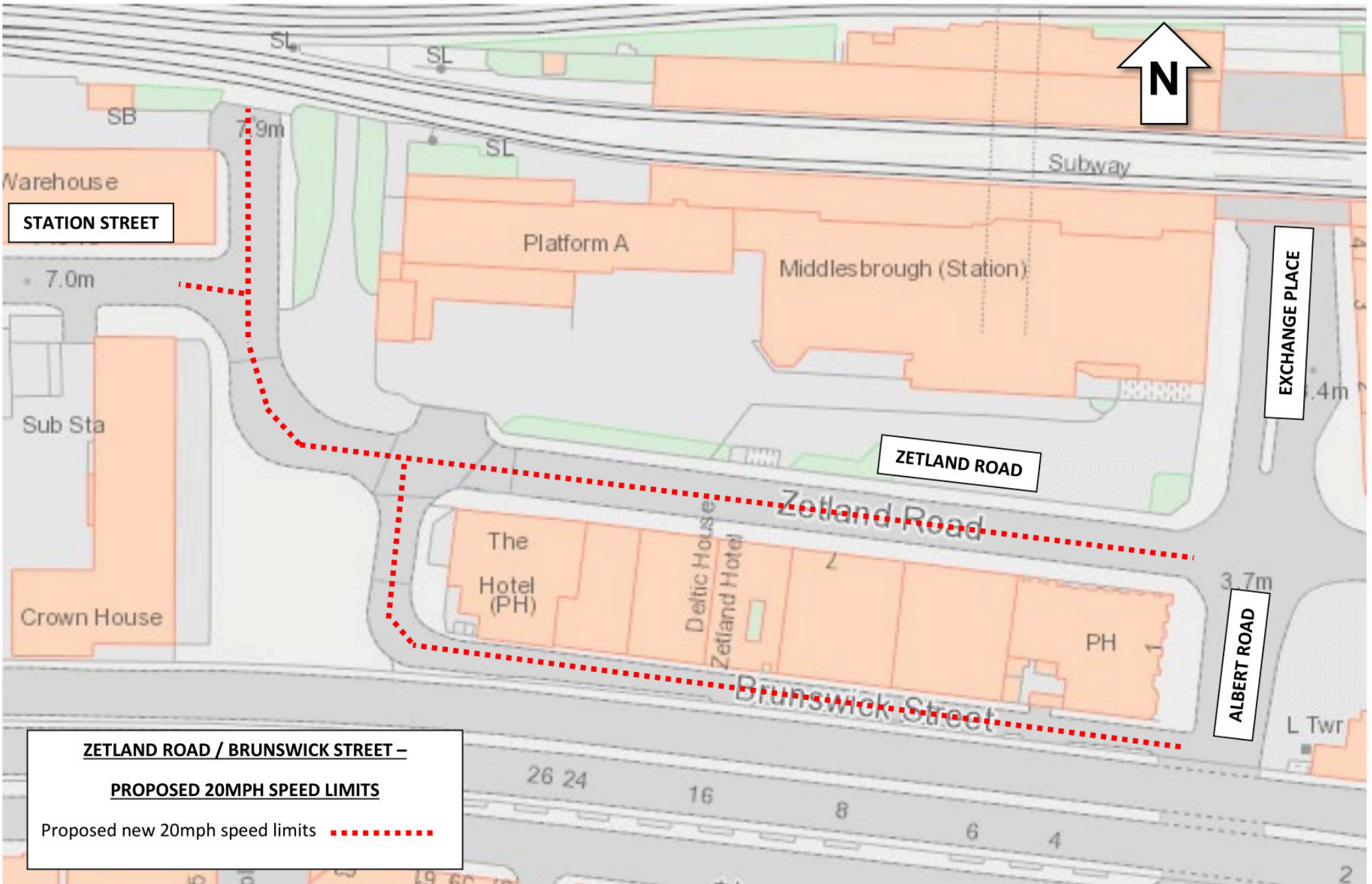

**ZETLAND ROAD / BRUNSWICK STREET –
 PROPOSED 20MPH SPEED LIMITS**
 Proposed new 20mph speed limits